



RETRACTABLE CASTERS

item no. 505592

INSTALLATION INSTRUCTIONS:

1. Insert the 4 casters (503816) into the holes of the plungers (503813).
2. For each pair of casters:
 - A. Line up with the holes provided on the Mark V bench ends making sure that 503808 foot pedal is to the front (side with the speed dial).
 - B. Just start one of the screws on one side.
 - C. On the opposite side, install and tighten screws.
 - D. Return to the other side, tighten the one screw (B above) and then install and tighten the second screw.

PARTS LIST:

Part No.		No. Req.
115546	Washer, 1/4 Lock	8
120372	Nut, 1/4-20	8
273814	Rollpin, short	4
456826	Rollpin, long	2
501566	Cam	4
503807	Rod drive	2
503808	Wheel foot pedal	2
503809	Bracket caster, R.H.	2
503811	Bracket caster, L.H.	2
503813	Plunger	4
503814	Spring	4
503815	Clip retaining	4
503816	Caster	4
503817	Tie rod	2
503822	Bolt, 1/4-20 5 x 8	8
513056	Set screw — 5/16-18 hex	2

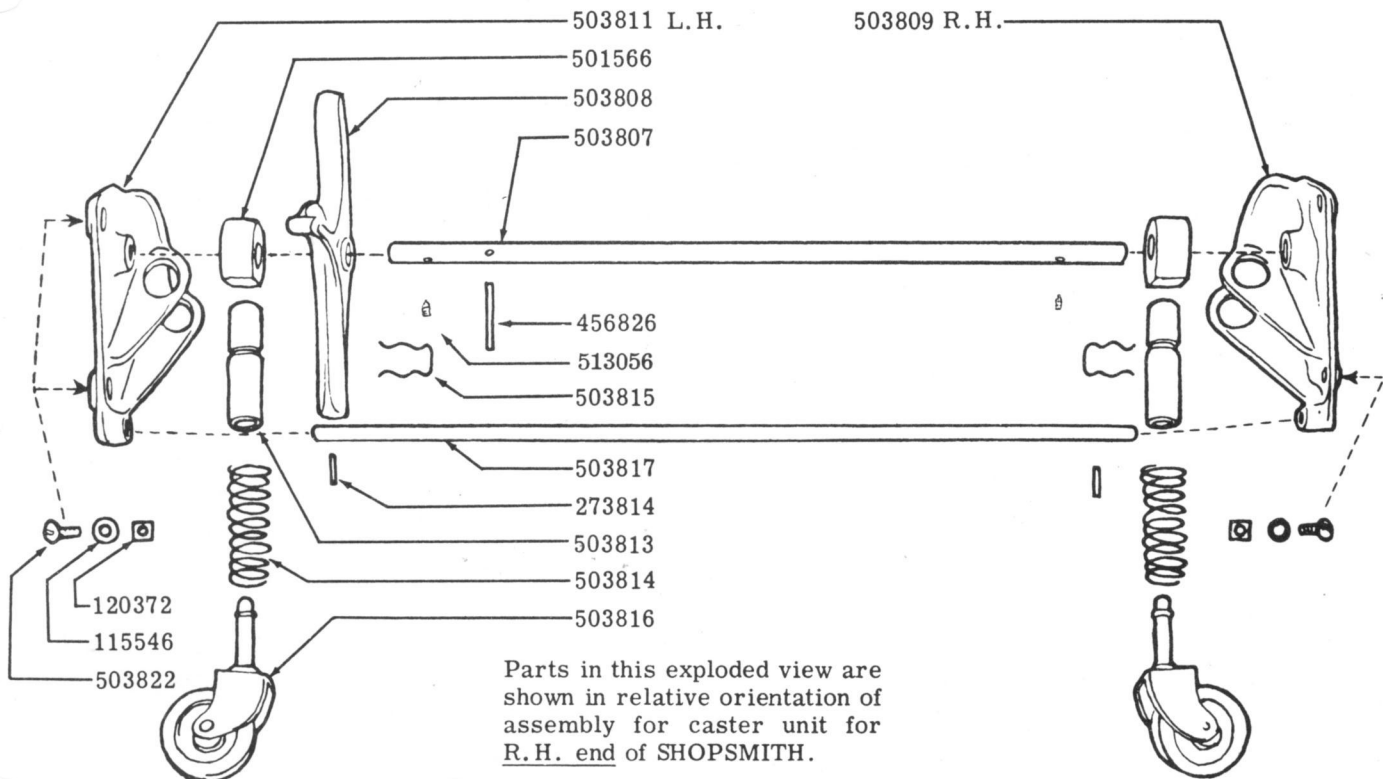

Parts in this exploded view are shown in relative orientation of assembly for caster unit for R.H. end of SHOPSMITH.



Shopsmith Inc.

750 Center Drive, Vandalia, Ohio 45377